



The right connection
The right environment

Quick Release Coupling QRC

Ref. No. H14014
Release: Apr 2025

ENGINEERING - 1 of 2

Description

QRC (Quick Release Couplings) are poppet type valves designed as per International standard, ISO 7241-1, Series "A"

Material of construction will be Carbon steel having surface treatment of Trivalent Zinc plating.

This series offers worldwide interchangeability and availability of sizes ranging from G 1/4 to G1

This makes 'QRC' series one of the most widely used in a range of hydraulic applications mainly in industrial and agriculture segments.

Some of the benefits are as under -

- The Poppet valve with Elastomer seal provides maximum sealing when disconnected.
- Compact Slim design
- Simple to use.



Section

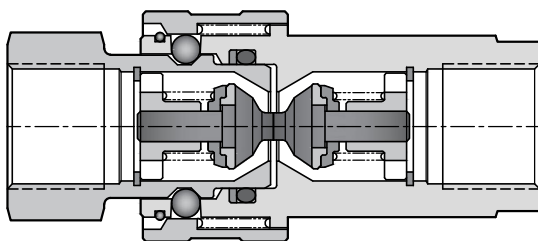

Hydraulic Symbol

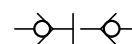

Unit Dimensions

End connections (Female threading)
BSP - G

Dimensions in mm.

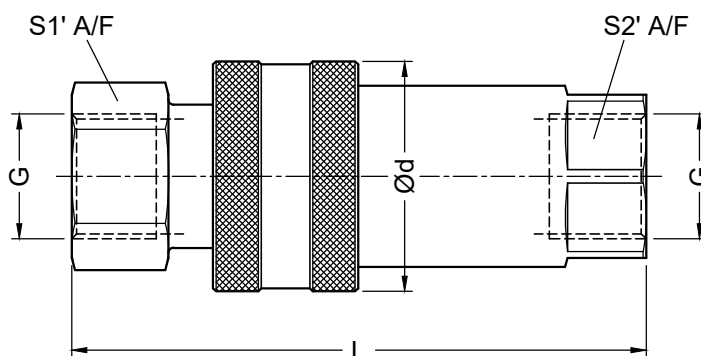

Table No. 1

G	Pressure (bar)	Ød	L	S1	S2
G 1/4	315	26	65	19	19
G 3/8	315	31	77	22	22
G 1/2	250	38	88	27	27
G 3/4	250	50	110	36	36
G1	250	55	127	41	41



The right connection
The right environment

Quick Release Coupling QRC

Ref. No. H14014
Release: Apr 2025

ENGINEERING - 2 of 2

Technical Specifications

Construction	Poppet type
Interchangeability	ISO 7241-1 series 'A'
Valve system	Poppet type
Mechanical connections	Locking Balls
Connection system	Pulling back the sleeve and pushing one half into other
Disconnect system	Pulling back the sleeve
Connection with residual pressure	Not allowed
Disconnection with residual pressure	Not allowed
Construction of material	Carbon steel
Surface treatment	Crome III Zinc plating
Seals	NBR
Operating pressure	Refer table no.1
Hydraulic medium	Mineral oil.
Viscosity range	10 cSt to 380 cSt.
Fluid temperature range	-20 °C to +80 °C.
Fluid cleanliness	As per ISO 4406 20/18/15
Max Flow handling capacity	

G 1/4	G 3/8	G 1/2	G 3/4	G 1
3 lpm	23 lpm	45 lpm	106 lpm	189 lpm

Ordering Code

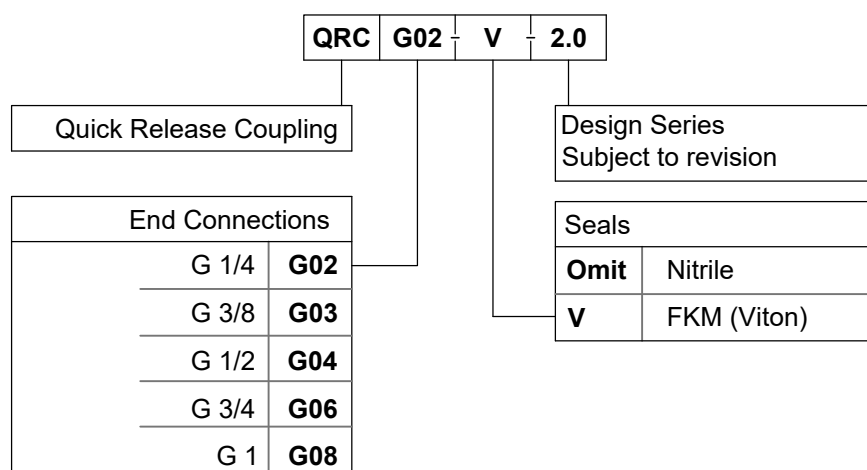

All rights reserved.
Subject to change without notice.
Due to continuous improvement in the design of the product, the actual product supplied may look different than shown above.