



The right connection
The right environment

Adjustable Throttle and Throttle Check Valves TT / TCT

Ref. No. H03364
Release: Apr 2025

ENGINEERING - 1 of 2

Description

Non pressure and viscosity compensated valves.

Model TT Throttle valves allow adjustable throttled flow in both the directions.

Model TCT throttle check valves gives adjustable flow in one direction and allows free flow in opposite direction.



Section

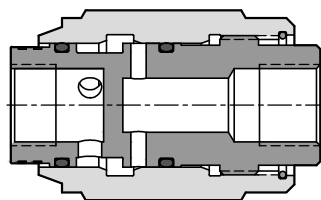

Model : TT

Hydraulic Symbol

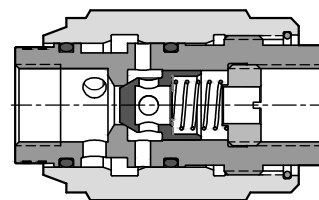

Model : TCT

Hydraulic Symbol

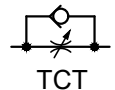

Unit Dimensions

Dimensions in mm.

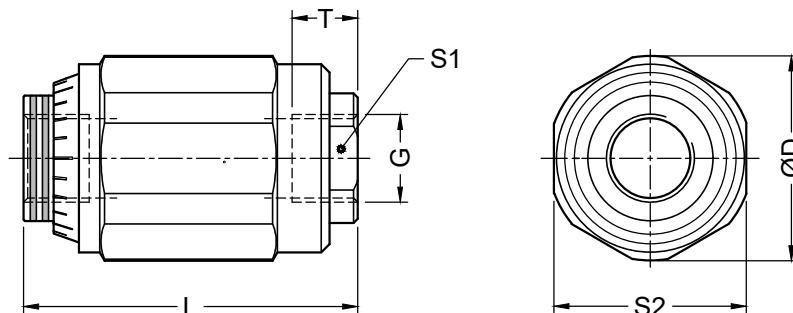

Part code		G	T	S1	S2	L	ØD	TCT Mass (Kg)	TT Mass (Kg)
TCTG02-2.0	TTG02-2.0	G 1/4	12	19	32	65	34	0.30	0.29
TCTG03-2.0	TTG03-2.0	G 3/8	13	22	36	65	38	0.35	0.33
TCTG04-2.0	TTG04-2.0	G 1/2	14	27	46	80	49	0.72	0.69
TCTG06-2.0	TTG06-2.0	G 3/4	18	32	55	100	58	1.25	1.20
TCTG08-2.0	TTG08-2.0	G 1	18	41	70	110	74	2.30	2.10
TCTG10-2.0	TTG10-2.0	G 1.1/4	22	50	85	130	87	3.80	3.60
TCTG12-2.0	TTG12-2.0	G 1.1/2	22	60	90	150	94	5.00	4.60



The right connection
The right environment

Adjustable Throttle and Throttle Check Valves TT / TCT

Ref. No. H03364
Release: Apr 2025

ENGINEERING - 2 of 2

Technical Specifications

Construction-----	Inline threaded body with rotating sleeve for flow adjustment. Non pressure and viscosity compensated.		
Mounting style -----	Inline, threaded body		
Mounting position -----	Optional		
Flow direction -----	For model TCT : Free flow in one direction. Adjustable throttled flow in opposite direction as indicated on the valve body. For model TT : Adjustable throttled flow in both the directions		
Operating pressure -----	315 bar.		
Hydraulic medium -----	Mineral oil.		
Viscosity range -----	10 cSt to 380 cSt.		
Fluid cleanliness requirement -----	As per ISO 4406 20/18/15		
Fluid temperature range -----	-20 °C to +70 °C		
Maximum flow handling capacity -----	TCTG02/TTG02 -----	25 l/min	
	TCTG03/TTG03 -----	40 /min	
	TCTG04/TTG04 -----	60 l/min	
	TCTG06/TTG06 -----	120 l/min	
	TCTG08/TTG08 -----	200 l/min	
	TCTG10/TTG10 -----	320 l/min	
	TCTG12/TTG12 -----	400 l/min	

Ordering Code

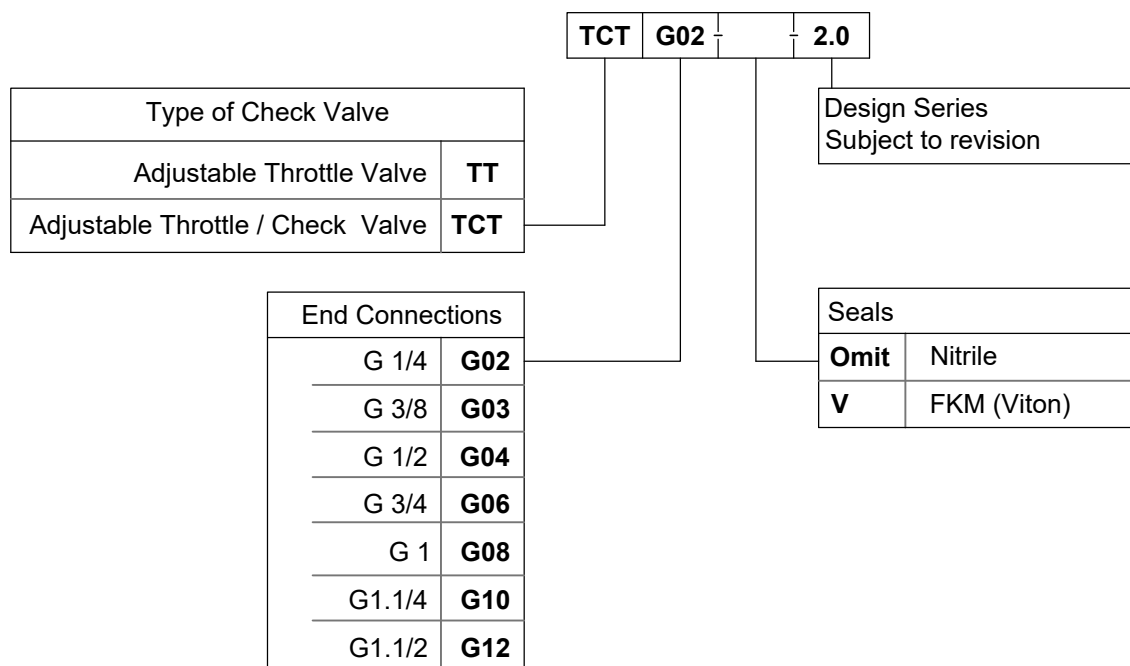

Note : Add prefix 316 to the above part code for SS 316 valves.
e.g. **316-TCTG02-2.0**