



The right connection
The right environment

Pressure Gauge Isolator Valve 1GI

Ref. No. H03154
Release: Apr 2025

ENGINEERING - 1 of 2

Description

Gauge Isolator valves, 1GI are meant for applications where a pressure gauge is connected to a pressure line and needs to be isolated when not in use. These can be mounted on a hydraulic manifold or a control panel.

These Isolator valves offer following advantages,

- Simple machining of the interface /panel
- Quick assembly,
- Ease of axial orientation of the Pressure gauge face for proper alignment.
- Compact and elegant assembly,
- Easy readability of the gauge.



Section

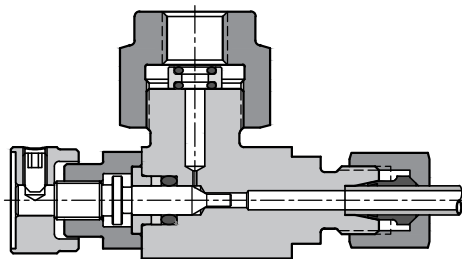

Panel Mounting, Model: 1GIP



Hydraulic Symbol

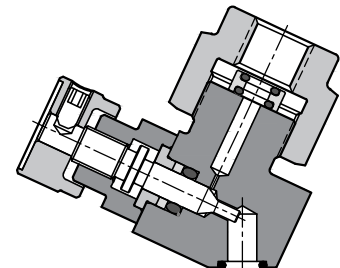

Sub-plate Mounting, Model: 1GIM

Unit Dimensions

Gauge Isolator Valve, Panel Mounting, Model: **1GIP**

Dimensions in mm.

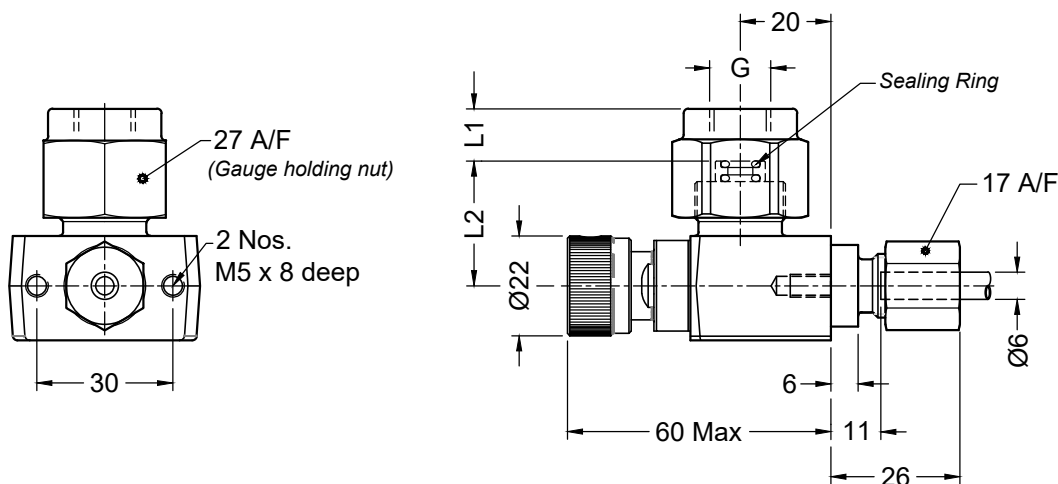
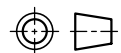

| G | G 1/4 | G 3/8 | G 1/2 |
|----|-------|-------|-------|
| L1 | 11.5 | 11.5 | 12.5 |
| L2 | 27.5 | 27.5 | 28.5 |



The right connection
The right environment

Pressure Gauge Isolator Valve 1GI

Ref. No. H03154
Release: Apr 2025

ENGINEERING - 2 of 2

Unit Dimensions

Gauge Isolator Valve, Subplate Mounting, Model: **1GIM**

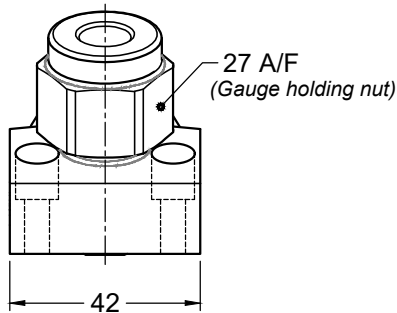

Mounting screws are not in scope of supply

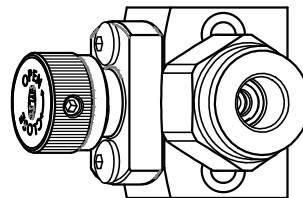
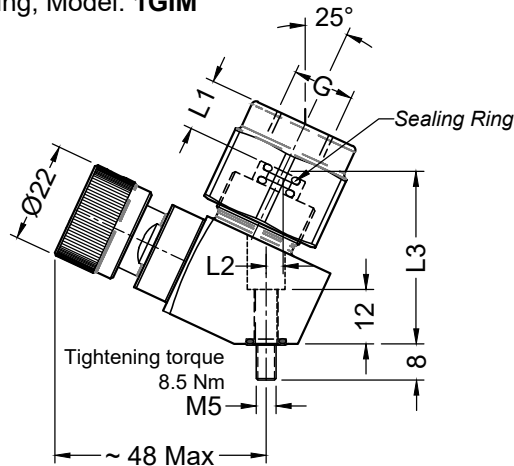

| G | G 1/4 | G 3/8 | G 1/2 |
|----|-------|-------|-------|
| L1 | 11.5 | 11.5 | 12.5 |
| L2 | 4.0 | 4.0 | 4.5 |
| L3 | 38.5 | 38.5 | 39.5 |

Mounting Interface

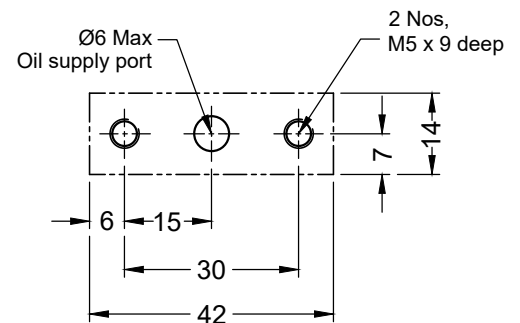

Technical Specifications

| | |
|-------------------------------|------------------------------------|
| Construction | Seat type |
| Mounting | Sub-plate mounted or Panel mounted |
| Interface standard | Factory standard. |
| Mounting position | Optional |
| Operating pressure | 350 bar. |
| Hydraulic medium | Mineral oil. |
| Fluid temperature range | -20 °C to +70 °C. |
| Fluid cleanliness requirement | As per ISO 4406 20/18/15 |

Instructions for Pressure Gauge assembly How to orient and tighten the gauge face to the desired position?

- Screw in the *Gauge holding Nut* onto the valve till its bottom face of it touches the face of the valve body.
- Insert the sealing ring provided with the valve, from the top of the nut.
- Screw in the gauge into the *Gauge Holding Nut* till its sealing face touches the sealing ring.
- Loosen the gauge (if required) by rotating it in anti-clockwise direction till the face of the gauge points towards desired position.
- Mount the Gauge Isolating Valve on to the sub-plate or panel.
- Rotate the Gauge Holding Nut by means of a spanner in anti-clockwise direction to tighten the gauge onto the sealing ring.
- While rotating the nut, hold the gauge to its proper orientation.

Ordering Code

| | | | | |
|--|------------|--------------------------------------|------------|------------|
| 1GI | | M | G02 | 2.0 |
| Gauge Isolator Valve (with hand knob) | | Design Series Subject to revision | | |
| Sub plate mounting | M | Seals | | |
| Panel mounting | P | | | |
| Gauge Port | | Omit Nitrile | | |
| G 1/4 | G02 | V FKM (Viton) | | |
| G 3/8 | G03 | | | |
| G 1/2 | G04 | | | |

Note : Add prefix 316 to the existing part code for SS 316 valves.
e.g. **316-1GIMG02-2.0**

All rights reserved.
Subject to change without notice.

Due to continuous improvement in the design of the product, the actual product supplied may look different than shown above.