



The right connection
The right environment

Shut off Valves, Sub-plate mounting **MSSL06**

Ref. No. H02651
Release: Apr 2025

ENGINEERING - 1 of 2

Description

Shut off valves model **MSSL06** are rising spindle, seat type valves with metal to metal seat for leak free closure between its port 'A' and Port 'B'

The mounting interface conforms to ISO 5781-AB-03-4-B.

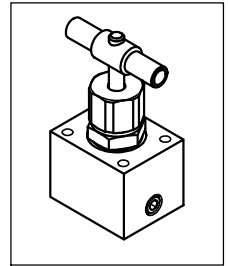

Section

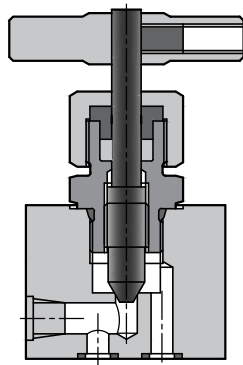

Hydraulic Symbol



Unit Dimensions

Dimensions in mm.

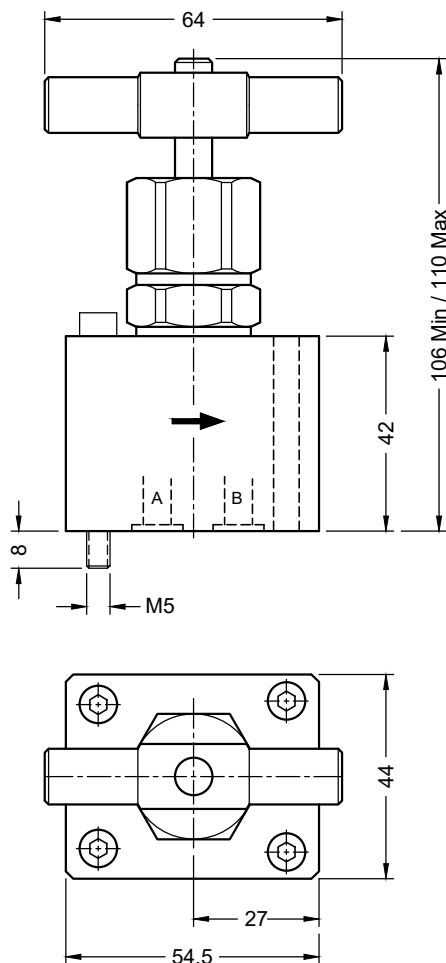

Mounting Interface

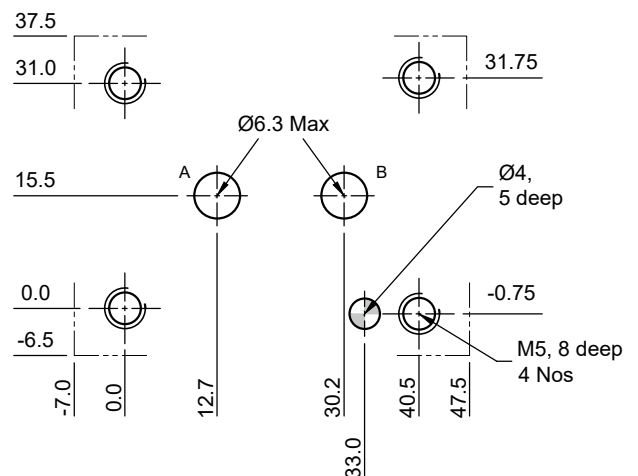

Required surface finish
on Interface area

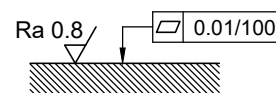

Valve mounting Screws : M5 x 50 Long (10.9) - 4 Nos.

Tightening Torque : 9 Nm



The right connection
The right environment

Shut off Valves, Sub-plate mounting **MSSL06**

Ref. No. H02651
Release: Apr 2025

ENGINEERING - 2 of 2

Technical Specifications

Construction-----	Seat type
Mounting type-----	Sub-plate mounting.
Mounting Interface-----	ISO 5781-AB-03-4-B
Mounting position -----	Optional
Flow direction-----	From 'A' to 'B'
Operating pressure -----	315 bar.
Hydraulic medium -----	Mineral oil.
Viscosity range -----	10 cSt to 380 cSt.
Fluid temperature range -----	-20 °C to +80 °C
Fluid cleanliness requirement -----	As per ISO 4406 20/18/15
Mass-----	0.9 Kg
Nom. flow handling capacity -----	Refer graph

Performance curves

Oil used : ISO VG 68
Viscosity : 68 cSt @ 40 °C
Test conducted at : 50 °C
Condition : Valve fully opened

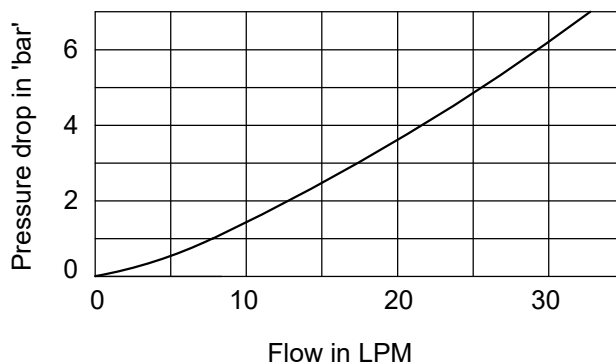

Ordering Code

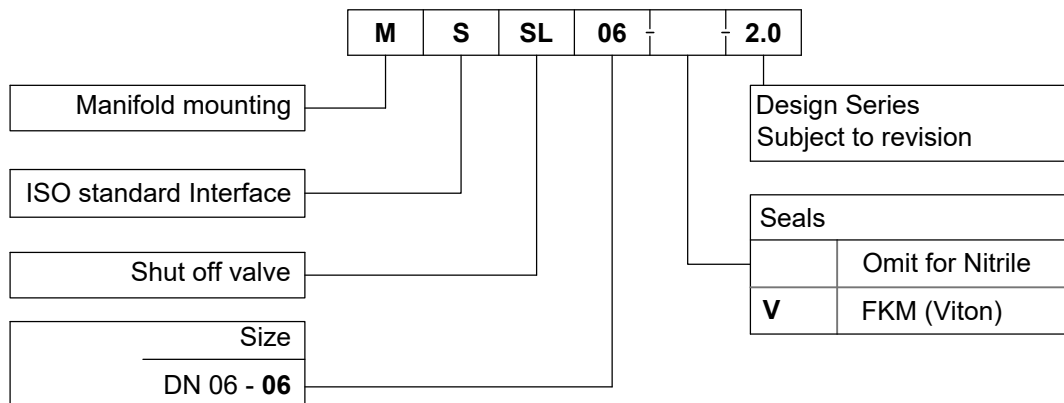

Note : Add prefix 316 to the above part code for SS 316 Valves.
e.g. **316-MSSL06-2.0**

All rights reserved.
Subject to change without notice.
Due to continuous improvement in the design of the product, the actual product supplied may look different than shown above.