

WFS Elbow Swivel flange connections

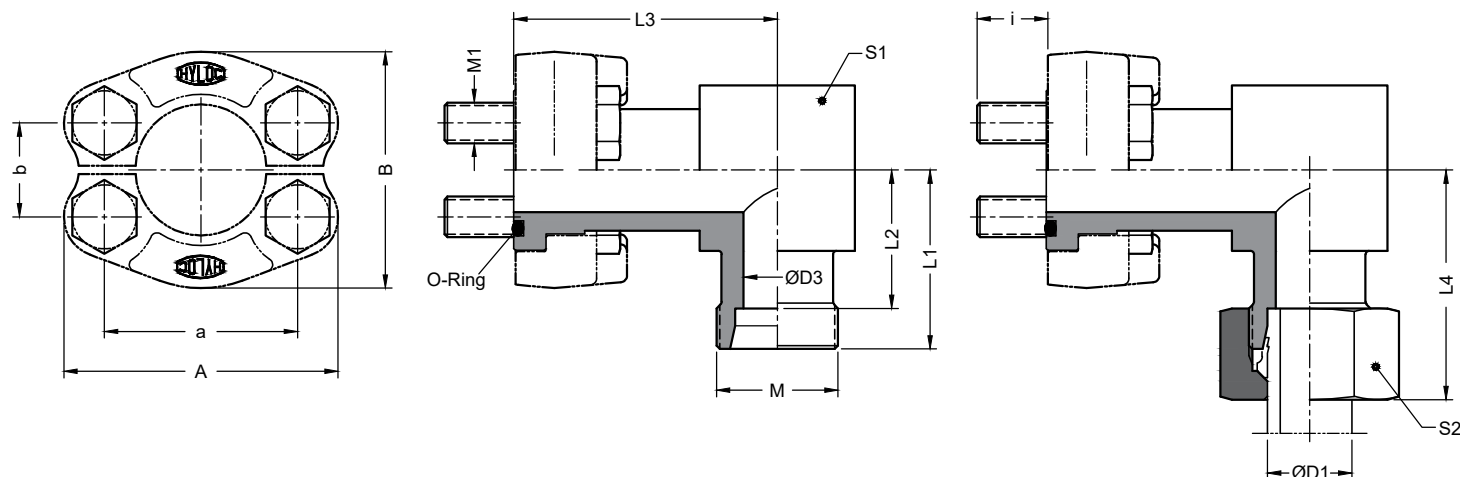

Mounting Interface conforms to ISO 6162 - 1

Dimensions in mm



Standard Pressure Series (Code 61)

Part No. Body	Part No. Assembly	Pr. (bar)	D1 	D3	M	Flange Nominal Size	Nominal DN Size	A	a	B	b	i	O Ring ID x CSD	Screw Size (10.9) M1
WFS3215XL	WFS3215PL	315	15	12	M22x1.5	1/2	13	54	38.1	46	17.5	12	19.0 x 3.55	M8 x 25
WFS3216XS	WFS3216PS	350	16	12	M24x1.5									
WFS3318XL	WFS3318PL	315	18	15	M26x1.5	3/4	19	65	47.6	52	22.3	16	25.0 x 3.55	M10 x 30
WFS3322XL	WFS3322PL	160	22	19	M30x2.0									
WFS3320XS	WFS3320PS	350	20	16	M30x2.0									
WFS3325XS	WFS3325PS	350	25	17	M36x2.0									
WFS3428XL	WFS3428PL	160	28	24	M36x2.0	1	25	70	52.4	59	26.2	14	32.5 x 3.55	M10 x 30
WFS3430XS	WFS3430PS	350	30	24	M42x2.0									
WFS3535XL	WFS3535PL	160	35	30	M45x2.0	1.1/4	32	79	58.7	73	30.2	16	37.5 x 3.55	M10 x 30
WFS3525XS	WFS3525PS	280	25	20	M36x2.0									
WFS3530XS	WFS3530PS	280	30	25	M42x2.0									
WFS3538XS	WFS3538PS	280	38	28	M52x2.0									
WFS3642XL	WFS3642PL	160	42	36	M52x2.0	1.1/2	38	94	69.9	83	35.7	19	47.5 x 3.55	M12 x 35
WFS3638XS	WFS3638PS	210	38	32	M52x2.0									

Part No. Body	Part No. Assembly	Pr. (bar)	D1 	L1	L2	L3	L4	S1	S2
WFS3215XL	WFS3215PL	315	15	36.0	29.0	45.5	47.5	27	27
WFS3216XS	WFS3216PS	350	16	38.0	29.5	45.5	51.0	27	30
WFS3318XL	WFS3318PL	315	18	39.0	31.5	52.5	51.0	27	32
WFS3322XL	WFS3322PL	160	22	41.0	33.5	54.0	53.5	30	36
WFS3320XS	WFS3320PS	350	20	43.0	32.5	54.0	58.0	30	36
WFS3325XS	WFS3325PS	350	25	45.0	33.0	57.0	60.0	36	46
WFS3428XL	WFS3428PL	160	28	44.0	36.5	57.0	57.5	36	41
WFS3430XS	WFS3430PS	350	30	50.0	36.5	62.0	67.5	46	50
WFS3535XL	WFS3535PL	160	35	87.0	46.5	69.0	102.5	46	50
WFS3525XS	WFS3525PS	280	25	55.0	43.0	69.0	71.0	46	46
WFS3530XS	WFS3530PS	280	30	57.0	43.5	69.0	74.5	46	50
WFS3538XS	WFS3538PS	280	38	59.0	43.0	73.5	77.5	55	60
WFS3642XL	WFS3642PL	160	42	58.0	47.0	73.5	73.5	55	60
WFS3638XS	WFS3638PS	210	38	64.0	48.0	73.5	82.5	55	60

Note :

Split flanges are not in the scope of supply.

While ordering these assemblies along with Split flanges, add suffix - **SFS** to the assembly part numbers.

Example : **WFS3430PS-SFS**

While ordering these assemblies along with Split flanges and also mounting hardwares, further add suffix - **BKM** to the assembly part numbers.

Example : **WFS3430PS-SFS/BKM**

Screw lengths are calculated for steel. Use of other material require different screw lengths.

WFS Elbow Swivel flange connections

Mounting Interface conforms to ISO 6162 - 2

Dimensions in mm

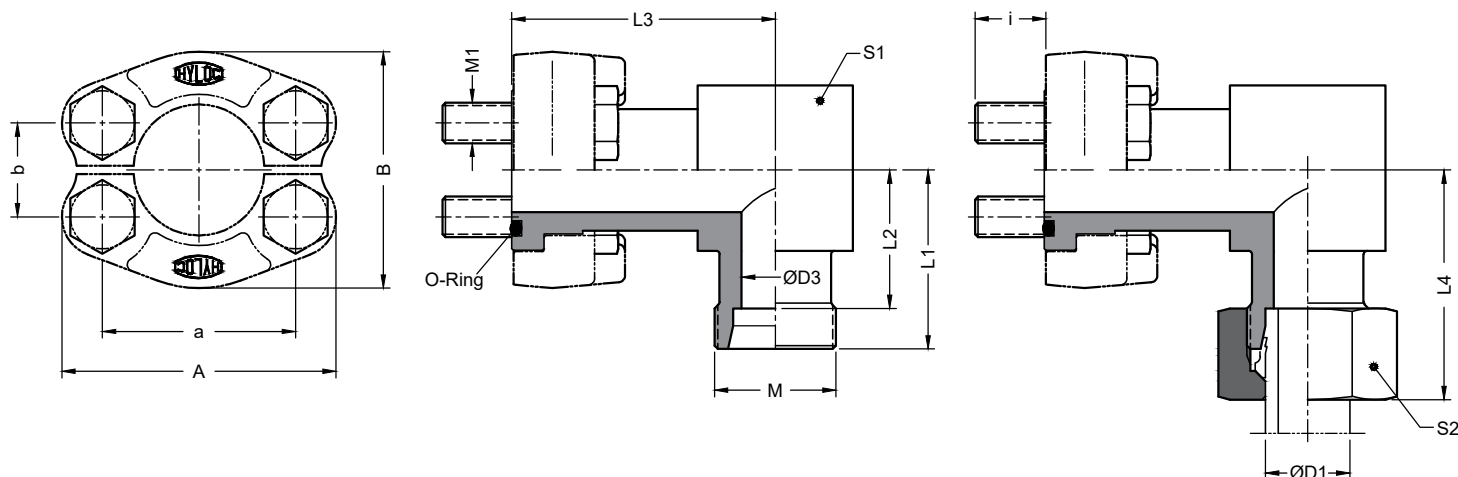

High Pressure Series (Code 62)

Part No. Body	Part No. Assembly	Pr. (bar)	D1 	D3	M	Flange Nominal Size	Nominal DN Size	A	a	B	b	i	O Ring ID x CSD	Screw Size (10.9) M1
WFS6216XS	WFS6216PS	400	16	12	M24x1.5	1/2	13	56	40.5	48	18.2	14	19.0 x 3.55	M8 x 30
WFS6316XS	WFS6316PS	400	16	12	M24x1.5	3/4	19	71	50.8	60	23.8	16	25.0 x 3.55	M10 x 35
WFS6320XS	WFS6320PS	400	20	16	M30x2.0									
WFS6325XS	WFS6325PS	400	25	17	M36x2.0									
WFS6425XS	WFS6425PS	400	25	20	M36x2.0	1	25	81	57.2	70	27.8	21	32.5 x 3.55	M12 x 45
WFS6430XS	WFS6430PS	400	30	24	M42x2.0									
WFS6530XS	WFS6530PS	400	30	25	M42x2.0	1.1/4	32	95	66.6	78	31.8	18	37.5 x 3.55	M12 x 45
WFS6538XS	WFS6538PS	315	38	30	M52x2.0									
WFS6638XS	WFS6638PS	315	38	30	M52x2.0	1.1/2	38	113	79.3	95	36.5	25	47.5 x 3.55	M16 x 55

Part No. Body	Part No. Assembly	Pr. (bar)	D1 	L1	L2	L3	L4	S1	S2
WFS6216XS	WFS6216PS	400	16	38.0	29.5	50.5	51.0	27	30
WFS6316XS	WFS6316PS	400	16	45.0	36.5	62.0	58.0	36	30
WFS6320XS	WFS6320PS	400	20	46.0	35.5	62.0	61.0	36	36
WFS6325XS	WFS6325PS	400	25	48.0	36.0	62.0	64.0	36	46
WFS6425XS	WFS6425PS	400	25	53.0	41.0	78.0	69.0	46	46
WFS6430XS	WFS6430PS	400	30	55.0	41.5	78.0	72.5	46	50
WFS6530XS	WFS6530PS	400	30	58.0	44.5	85.0	75.5	46	50
WFS6538XS	WFS6538PS	315	38	61.0	45.0	89.5	79.5	55	60
WFS6638XS	WFS6638PS	315	38	72.0	56.0	95.5	90.5	55	60

Note:

Split flanges are not in the scope of supply.

While ordering these assemblies along with Split flanges, add suffix - **SFS** to the assembly part numbers.Example : **WFS6430PS-SFS**While ordering these assemblies along with Split flanges and also mounting hardware, further add suffix - **BKM** to the assembly part numbers.Example : **WFS6430PS-SFS/BKM**

Screw lengths are calculated for steel. Use of other material require different screw lengths.