

# GE-MO Male Stud Couplings

24° Tube end as per ISO 8434-1

Dimensions in mm

Male Metric (M) threads with  
O' Ring sealing for port tappings  
according to ISO 6149 - 1 or  
DIN 3852, Part 3

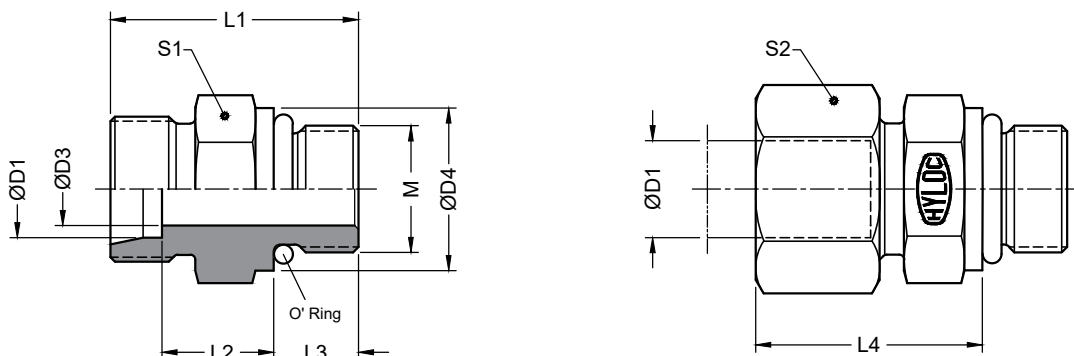

Series	Part No. Body	Part No. Assembly	D1	D3	M Male Metric thread	D4	L1	L2	L3	Approx. L4	S1	S2	O' Ring ID x CSD
L Light 315 bar	GE06XLMO	GE06PLMO	06	4	M10x1.0	14	25	8.5	9.5	26	14	14	8.1 x 1.6
	GE08XLMO	GE08PLMO	08	6	M12x1.5	17	28	10	11	27	17	17	9.3 x 2.2
	GE10XLMO	GE10PLMO	10	8	M14x1.5	19	29	11	11	29	19	19	11.3 x 2.2
	GE12XLMO	GE12PLMO	12	10	M16x1.5	22	32	12.5	12.5	30	22	22	13.3 x 2.2
	GE15XLMO	GE15PLMO	15	12	M18x1.5	24	34.5	13.5	14	32	24	27	15.3 x 2.2
	GE18XLMO	GE18PLMO	18	15	M22x1.5	27	37	14.5	15	34	27	32	19.3 x 2.2
160 bar	GE22XLM27O	GE22PLM27O	22	19	M27x2.0	32	42.5	16.5	18.5	36.5	32	36	23.6 x 2.9
	GE28XLMO	GE28PLMO	28	24	M33x2.0	41	43.5	17.5	18.5	38.5	41	41	29.6 x 2.9
	GE35XLMO	GE35PLMO	35	30	M42x2.0	50	47	17.5	19	43.5	50	50	38.6 x 2.9
	GE42XLMO	GE42PLMO	42	36	M48x2.0	55	52	19.5	21.5	46	55	60	44.6 x 2.9
S Heavy 630 bar 400 bar	GE06XSMO	GE06PSMO	06	4	M12x1.5	17	31	13	11	30.5	17	17	9.3 x 2.2
	GE08XSMO	GE08PSMO	08	5	M14x1.5	19	33	15	11	32	19	19	11.3 x 2.2
	GE10XSMO	GE10PSMO	10	7	M16x1.5	22	35	15	12.5	34.5	22	22	13.3 x 2.2
	GE12XSMO	GE12PSMO	12	8	M18x1.5	24	38.5	17	14	36	24	24	15.3 x 2.2
	GE16XSMO	GE16PSMO	16	12	M22x1.5	27	42	18.5	15	40	27	30	19.3 x 2.2
	GE20XSMO	GE20PSMO	20	16	M27x2.0	32	49.5	20.5	18.5	46	32	36	23.6 x 2.9
	GE25XSMO	GE25PSMO	25	20	M33x2.0	41	53.5	23	18.5	51	41	46	29.6 x 2.9
	GE30XSMO	GE30PSMO	30	25	M42x2.0	50	56	23.5	19	54.5	50	50	38.6 x 2.9
	GE38XSMO	GE38PSMO	38	32	M48x2.0	55	64	26.5	21.5	61	55	60	44.6 x 2.9

Assembly consists of Double bite ferrule.

For soft seal ferrules, replace 'P' with 'SRD' in Part code. Example : GE16SRDSMO

Standard material : Carbon Steel

For Stainless steel material, add prefix 316 - to the part code

Example : 316-GE16PSMO

Standard surface treatment : Chrome free Alkaline Zinc Plating.

For Zinc Nickel surface treatment, add suffix - ZnNi

Example : GE16PSMO-ZnNi